

IW- I Pad 10

INTERACTIVE WIRELESS PAD



Interact Anywhere, Anytime

The IW- I Pad 10 is a light weight graphic tablet that enables you to control your lessons or presentations from anywhere in the room. Featuring Wi-Fi technology, the new IW- I Pad 10 is easy to install and simple to operate.

Wireless Control



With IW- I Pad 10 you can comfortably control your lessons, presentations and software applications upto 10 mtrs.away from your computer.

Involve the Audience



The device can be passed around the classroom or Group members to contribute to lessons, training sessions or meetings Without leaving their seat.

Easy to Operate

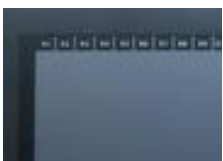

The IW-I Pad 10 features 16 buttons And an electronic wireless pen to ensure easy control of interactive white board From anywhere in the room.

Multiple Uses



upto 7 devices can be connected to one PC at the same time for Interactive Group work.

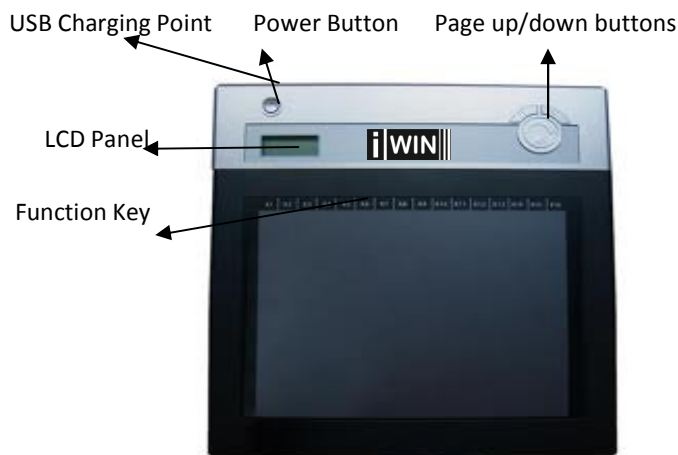

Key Features:

- Up to 16 hours of wireless operations
- Recharge battery via USB.
- Wireless pen with 2 customizable buttons
- Supports multiple pairing up to 7 devices
- 16 function buttons
- Built-in LCD indicator panel
- Enabled for simultaneous viewing and annotation by multiple systems

Accessories



i WIN Board software bundled



Various import & export formats.
 Variety of Ink Pens available.
 Hand writing recognition.
 10,000 images & animations

Technical Parameters IW- I Pad 10

Model No. IW-I Pad 10	Battery life Approximately 1680 hours	Resolution 2000pi	Power Source: USB Charged
Technology Electromagnetic	Power supply Li-ion rechargeable battery	Proximity 10mm	i WIN Board Software & Tablet driver
Wireless Medium Wireless 2.4G RF	Battery usage time 16 hours (Continuous use)	Pen Input Battery operated electronic Pen with 2 buttons	Windows Operating System Microsoft Windows 2000/XP/Vista/WIN 7/Linux
Pad size (mm) 254	Operating Specification +5 to 40°C	Pen Battery AAA battery x 1 (1.5V)	System Requirements: CPU: Pentium 4, RAM: 512MB; HDD 200MB; Internet Explorer 6/7/8; Microsoft Office 2002/2003/2007; Adobe Acrobat Reader 5.05; Adobe Reader 6/7/8/9; Microsoft Visio 2002/2003/2007; Microsoft Project 2002/2003; Microsoft DirectX 9.0c or higher; Window Media Encoder etc.
Dimensions (mm) 275 (H) x 265 (W) x 20 (D)	Safety Standard approvals CE, FCC	Interface to Computer USB 1.1 (USB 2.0 compatible)	
Weight 640 g	Packing dimension (mm) 298 (W) x 298 (H) x 45 (D)	RF range Up to 10m (limited condition)	
Sampling Rate 120 points/s	Function button 16 buttons	Hot Keys: Page up/Page down	

Annotation Software:

Annotation software includes: annotate, shape, sizes, erase, color, draw, choose, Pens, text, edit, fonts, stamp, move, capture, picture, video, save, rotate, undo, image gallery, print, floating keyboard, background, import, export, user selection, spotlight, wrap screen, geometrical tools etc.



ABC Infosystems Pvt. Ltd.

Regd. Off.: 1/3, 2nd Floor, East Patel Nagar, New Delhi-110008
 Branch Off: B-64, Basement, Indepuri, New Delhi-110012
 Ph.: +91-11- 45138349, 25885337,
 Cell: +91-98100 76839; 93100 76839
 Email: anjani@abcinfo.in; anjanijaiswal@yahoo.com